

LASCO[®]
Fittings, Inc.

NSF-pw

TECHNICAL DATA

SCHEDULE

80 CPVC PIPE FITTINGS

Information contained in this publication is provided as a Preliminary Guide. Interpretation and application are functions of the user.

Schedule 80 CPVC

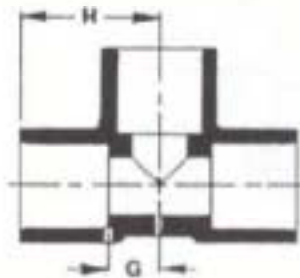

Tee
slip x slip x slip

Part No.	Size	G	H
9801-005	1/2	1/2	1 3/8
9801-007	3/4	9/16	1 9/16
9801-010	1	3/4	1 7/8
9801-012	1 1/4	7/8	2 1/8
9801-015	1 1/2	1	2 3/8
9801-020	2	1 1/4	2 3/4
9801-025	2 1/2	1 1/2	3 1/4
9801-030	3	1 13/16	3 11/16
9801-040	4	2 9/32	4 17/32
9801-060	6	*	*
9801-080	8	*	*

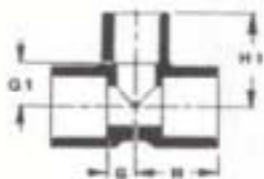

Reducing Tee
slip x slip x slip

Part No.	Size	G	H	G1	H1
9801-101	3/4 x 3/4 x 1/2	1/2	1 17/32	3/4	1 5/8
9801-130	1 x 1 x 1/2	1/2	1 21/32	3/4	1 5/8
9801-131	1 x 1 x 3/4	23/32	1 29/32	3/4	1 3/4

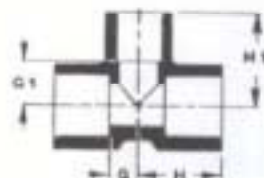

Tee
slip x slip x fipt

Part No.	Size	G	H	G1	H1
9802-005	1/2	1/2	1 3/8	15/32	1 5/32
9802-007	3/4	3/4	1 13/16	5/8	1 3/4
9802-010	1	3/4	1 7/8	13/16	1 7/8

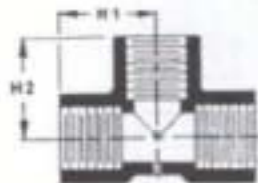

Tee
fipt x fipt x fipt

Part No.	Size	H1	H2
9805-005	1/2	1 13/32	1 11/32
9805-007	3/4	1 9/32	1 9/32
9805-010	1	1 7/8	1 7/8
9805-012	1 1/4	2 3/16	2 3/16
9805-015	1 1/2	2 7/16	2 13/32
9805-020	2	2 9/32	2 1/4



90 Deg Ell
slip x slip

Part No.	Size	G	H
9806-002	1/4	*	*
9806-005	1/2	1/2	1 3/8
9806-007	3/4	9/16	1 9/16
9806-010	1	11/16	1 13/16
9806-012	1 1/4	7/8	2 1/8
9806-015	1 1/2	1 1/16	2 7/16
9806-020	2	1 1/4	2 3/4
9806-025	2 1/2	1 1/2	3 23/32
9806-030	3	1 13/16	3 11/16
9806-040	4	2 5/16	4 19/32
9806-060	6	3 1/2	6 1/2
9806-080	8	*	*

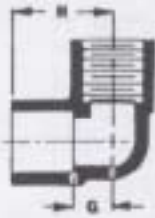

90 Deg Ell
slip x flt

Part No.	Size	G	H
9807-005	1/2	17/32	1 3/8
9807-007	3/4	3/4	1 3/4
9807-010	1	3/4	1 7/8
9807-012	1 1/4	25/32	2 1/8
9807-015	1 1/2	1 3/32	2 1/2
9807-020	2	1 7/32	2 3/4

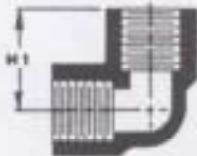

90 Deg Ell
flt x flt

Part No.	Size	H1
9808-005	1/2	1 3/8
9808-007	3/4	1 7/8
9808-010	1	2 7/32
9808-012	1 1/4	2 7/32
9808-015	1 1/2	2 3/8
9808-020	2	2 1/4

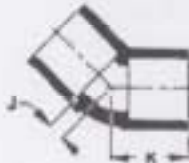

45 Deg Ell
slip x slip

Part No.	Size	J	K
9817-002	1/4	*	*
9817-005	1/2	5/16	1 3/16
9817-007	3/4	15/32	1 3/8
9817-010	1	11/32	1 1/2
9817-012	1 1/4	15/32	1 23/32
9817-015	1 1/2	17/32	1 15/16
9817-020	2	21/32	2 5/32
9817-025	2 1/2	1 1/32	2 29/32
9817-030	3	1 1/32	2 29/32
9817-040	4	1 7/32	3 1/2
9817-060	6	*	*
9817-080	8	*	*

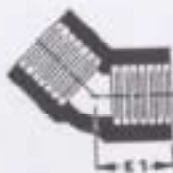

45 Deg Ell
flt x flt

Part No.	Size	K	J
9819-005	1/2	*	*
9819-007	3/4	*	*
9819-010	1	*	*
9819-012	1 1/4	*	*
9819-015	1 1/2	*	*
9819-020	2	*	*

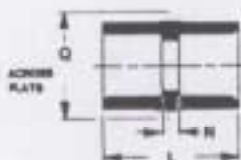

Coupling
slip x slip

Part No.	Size	L	N	Q
9829-002	1/4	*	*	
9829-005	1/2	2 1/32	1/4	1 11/32
9829-007	3/4	2 9/32	1/4	1 9/16
9829-010	1	2 17/32	9/32	1 27/32
9829-012	1 1/4	2 13/16	1/4	2 3/16

Schedule 80 CPVC



Coupling
slip x slip

Part No.	Size	L	N	Q
9829-015	1 1/2	3 1/32	1/4	2 17/32
9829-020	2	3 5/16	1/4	3
9829-025	2 1/2	3 3/4	1/4	3 5/8
9829-030	3	4	1/4	4 3/8
9829-040	4	4 23/32	3/16	
9829-060	6	6 5/16	3/16	
9829-080	8	*	*	*

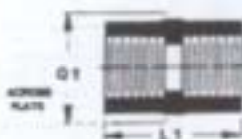

Coupling
flpt x flpt

Part No.	Size	L	Q
9830-005	1/2	2 1/32	1 11/32
9830-007	3/4	2 9/32	1 17/32
9830-010	1	2 17/32	1 27/32
9830-012	1 1/4	2 13/16	2 7/32
9830-015	1 1/2	3 1/32	2 17/32
9830-020	2	3 9/32	3 1/32

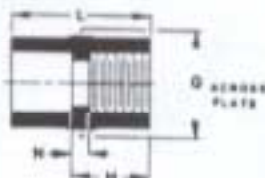

Female Adapter
slip x flpt

Part No.	Size	H	L	N	Q
9835-002	1/4	*	*	*	*
9835-005	1/2	1 5/32	2 031/32	1/4	1 11/32
9835-007	3/4	1 5/16	2 7/32	1/4	1 9/16
9835-010	1	1 3/8	2 1/2	1/4	1 27/32
9835-012	1 1/4	1 17/32	2 13/16	9/32	2 7/32
9835-015	1 1/2	1 21/32	3 1/32	5/16	2 17/32
9835-020	2	1 25/32	3 5/16	5/16	3 1/32
9835-030	3	*	*	*	*
9835-040	4	*	*	*	*



Male Adapter
mipt x slip

Part No.	Size	H	L	Q
9836-005	1/2	1	1 7/8	1 7/32
9836-007	3/4	1 3/16	2 3/16	1 7/16
9836-010	1	1 1/4	2 3/8	1 3/4
9836-012	1 1/4	1 9/32	2 17/32	2 1/8
9836-015	1 1/2	2 21/32	2 21/32	2 3/8
9836-020	2	1 3/8	2 7/8	2 29/32
9836-040	4	*	*	*



Reducer Bushing
sp x slip

Part No.	Size	L	R	Q
9837-072	1/2 x 1/4	*	*	*
9837-101	3/4 x 1/2	1 3/32	1/4	1 3/32
9837-130	1 x 1/2	1 1/4	1/4	1 11/32
9837-131	1 x 3/4	1 1/4	1/4	1 3/8

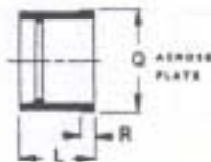

Reducer Bushing
sp x slip

Part No.	Size	L	R	Q
9837-166	1 1/4 x 1/2	*	*	*
9837-167	1 1/4 x 3/4	*	*	*
9837-168	1 1/4 x 1	1 19/32	5/16	1 13/16
9837-209	1 1/2 x 1/2	*	*	*
9837-210	1 1/2 x 3/4	*	*	*
9837-211	1 1/2 x 1	1 11/16	5/16	2 1/32
9837-212	1 1/2 x 1 1/4	1 11/16	5/16	2 1/16
9837-247	2 x 1/2	*	*	*
9837-248	2 x 3/4	*	*	*
9837-249	2 x 1	*	*	*
9837-250	2 x 1 1/4	*	*	*
9837-251	2 x 1 1/2	1 13/16	5/16	2 7/16
9837-292	2 1/2 x 2	*	*	*
9837-337	3 x 1 1/2	*	*	*
9837-338	3 x 2	*	*	*
9837-339	3 x 2 1/2	*	*	*
9837-420	4 x 2	*	*	*
9837-422	4 x 3	*	*	*
9837-532	8 x 4	3 17/32	1/2	6 23/32



Reducer Bushing
sp x fipt

Part No.	Size	L1	R1	Q1
9838-101	3/4 x 1/2	1 1/32	1/4	1 3/32
9838-130	1 x 1/2	1 1/32	1/4	1 3/8
9838-131	1 x 3/4	1 1/4	1/4	1 11/32
9838-168	1 1/4 x 1	1 9/16	5/16	1 27/32
9838-209	1 1/2 x 1/2	*	*	*
9838-210	1 1/2 x 3/4	*	*	*
9838-211	1 1/2 x 1	1 5/8	5/16	2 1/32
9838-212	1 1/2 x 1 1/4	1 25/32	5/16	2 3/32
9838-248	2 x 3/4	*	*	*
9838-249	2 x 1	*	*	*
9838-251	2 x 1 1/2	1 13/16	5/16	2 7/16
9838-292	2 1/2 x 2	*	*	*
9838-338	3 x 2	*	*	*
9838-422	4 x 3	*	*	*

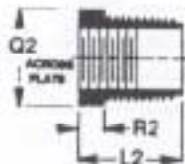

Reducer Bushing
mipt x fipt

Part No.	Size	L2	R2	Q2
9839-101	3/4 x 1/2	1 1/32	5/16	1 1/16
9839-131	1 x 3/4	1 1/8	5/16	1 11/32
9839-168	1 1/4 x 1	1 3/8	13/32	1 7/8
9839-212	1 1/2 x 1 1/4	1 7/16	13/32	1 31/32
9839-251	2 x 1 1/2	1 7/16	3/8	2 7/16



Cap
slip

Part No.	Size	H	L
9847-005	1/2	5/16	1 7/32
9847-007	3/4	9/32	1 3/8
9847-010	1	13/32	1 5/8

Schedule 80 CPVC



Cap slip

Part No.	Size	H	L
9847-012	1 1/4	1/2	1 13/16
9847-015	1 1/2	17/32	2
9847-020	2	5/8	2 3/16
9847-025	2 1/2	13/16	2 11/16
9847-030	3	1	3
9847-040	4	21/32	2 31/32
9847-060	6	*	*



Cap fip

Part No.	Size	L1
9848-005	1/2	1 1/4
9848-007	3/4	1 13/32
9848-010	1	1 19/32
9848-012	1 1/4	1 25/32
9848-015	1 1/2	2
9848-020	2	2 5/32
9848-030	3	2 31/32
9848-040	4	2 29/32

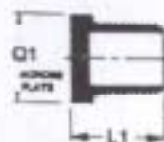

Plug mipt

Part No.	Size	L1	Q1
9850-002	1/4	*	*
9850-005	1/2	1 1/32	31/32
9850-007	3/4	1 1/32	1 3/32
9850-010	1	1 1/4	1 9/16
9850-012	1 1/4	1 5/16	1 25/32
9850-015	1 1/2	1 11/32	1 15/16
9850-020	2	1 3/8	2 7/16
9850-030	3	*	*
9850-040	4	*	*



Class 150 Flange one piece slip

Part No.	Size	L	M	N	Q
9851-005	1/2	1 1/32	3 17/32	1/8	15/32
9851-007	3/4	1 5/32	3 29/32	5/32	17/32
9851-010	1	1 9/32	4 9/32	5/32	19/32
9851-012	1 1/4	1 13/32	4 21/32	5/32	5/8
9851-015	1 1/2	1 9/16	5 1/16	5/32	11/16
9851-020	2	1 11/16	6 1/32	3/16	25/32
9851-025	2 1/2	*	*	*	*

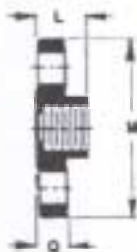

Class 150 Flange one piece fip

Part No.	Size	L	M	Q
9852-005	1/2	*	*	*
9852-007	3/4	31/32	3 7/8	9/16
9852-010	1	*	*	*
9852-012	1 1/4	*	*	*
9852-014	1 1/2	*	*	*
9852-020	2	*	*	*
9852-030	3	*	*	*
9852-040	4	*	*	*

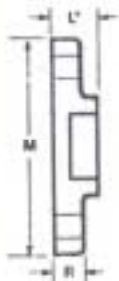

**Class 150 Flange
one piece
Blind**

Part No.	Size	M	L	R
9853-015	1 1/2	*	*	*
9853-020	2	*	*	*
9853-030	3	*	*	*

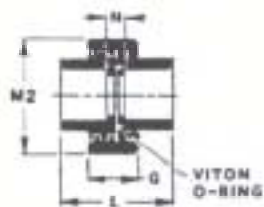

**Union
slip x slip**

Part No.	Size	G	L	M2	N
9897-002	1/4	*	*	*	*
9897-005	1/2	31/32	2 3/16	2 1/8	13/32
9897-007	3/4	1	2 15/32	2 1/2	13/32
9897-010	1	1 3/32	2 23/32	2 15/16	13/32
9897-012	1 1/4	*	*	*	*
9897-015	1 1/2	*	*	*	*
9897-020	2	*	*	*	*
9897-030	3	*	*	*	*

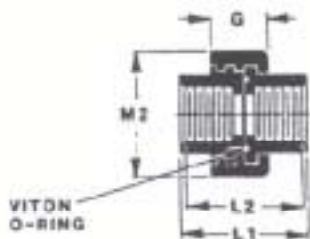

**Union
fipt x fipt**

Part No.	Size	L1
9898-005	1/2	*
9898-007	3/4	*
9898-010	1	*
9898-012	1 1/4	*
9898-015	1 1/2	*
9898-020	2	*

Schedule 80 CPVC

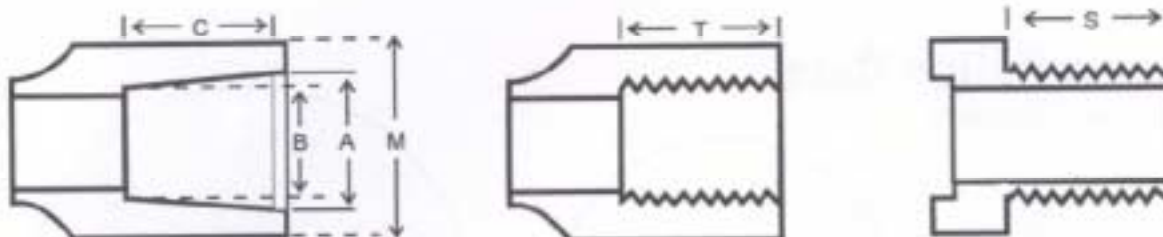

Size	Pipe O.D.	A (entrance)		B (bottom)		Max. Out Of Round	C (socket) Depth (Min.)	T (thread) Female (Min.)	S (thread) Male (Min.)	M*
		Min.	Max.	Min.	Max.					
1/4	0.540	0.548	0.556	0.530	0.540	± .008	0.625	0.540	0.460	-
3/8	0.675	0.683	0.691	0.667	0.675	± .008	0.750	0.540	0.460	-
1/2	0.840	0.844	0.852	0.832	0.840	± .008	0.875	0.690	0.620	1.290
3/4	1.050	1.054	1.062	1.042	1.050	± .010	1.000	0.700	0.620	1.520
1	1.315	1.320	1.330	1.305	1.315	± .010	1.125	0.860	0.790	1.820
1 1/4	1.660	1.665	1.675	1.650	1.660	± .012	1.250	0.900	0.790	2.220
1 1/2	1.900	1.906	1.918	1.888	1.900	± .012	1.375	0.900	0.840	2.520
2	2.375	2.381	2.393	2.363	2.375	± .012	1.500	0.950	0.840	3.020
2 1/2	2.875	2.882	2.896	2.861	2.875	± .015	1.750	1.300	1.260	3.580
3	3.500	3.508	3.524	3.484	3.500	± .015	1.875	1.390	1.320	4.330
4	4.500	4.509	4.527	4.482	4.500	± .015	2.250	1.470	1.420	5.450
6	6.625	6.636	6.658	6.603	6.625	± .030	3.000	-	-	7.590
8	8.625	8.640	8.670	8.595	8.625	± .045	4.000	-	-	9.745

1/4 to 1 1/2 = ±1/32
2 to 8 = ±1/16

Maximum Pipe Operating Pressure

Pipe Size	Maximum Operating Pressure (p.s.i.) at 73.4°F	
	CPVC Pipe Schedule 80 Plain Ends	CPVC Pipe Schedule 80 Threaded Ends
1/2	850	420
3/4	690	340
1	630	320
1 1/4	520	260
1 1/2	470	240
2	400	200
2 1/2	420	210
3	370	190
4	320	160
5	290	Not Recommended
6	280	Not Recommended
8	250	Not Recommended

Do not use CPVC pipe fittings for steam or any other compressed air systems.

Temperature Correction Factors

Operating Temperature (°F)	PVC Pressure Rating Factor
75	1.00
80	1.00
90	0.92
100	0.85
110	0.75
120	0.65
130	0.57
140	0.50
150	0.45
160	0.40
170	0.32
180	0.25
190	0.22
200	0.20
210	0.15
220	Not Recommended

Not recommended above 210 °F. For more severe service, an additional correction factor may be required.

Flange Installation Data

Torque Sequence

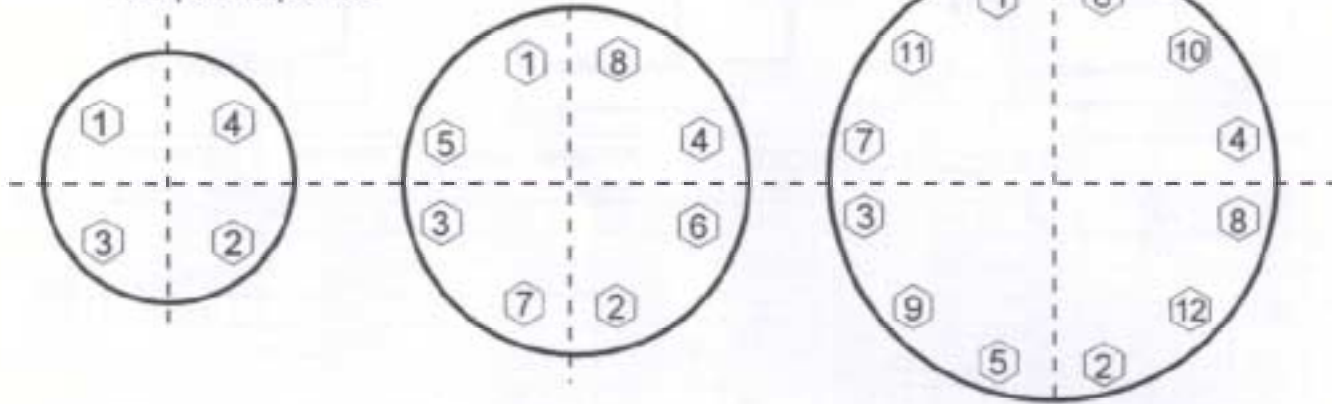

1. Recommended Gaskets: full face, 1/8" thick, elastomeric, 50-70 Shore A hardness.
2. Bolt Threads should be well-lubricated.
3. Nut and bolt threads should be free-running during assembly.
4. Follow illustrated bolt-tightening Sequence.
5. Always use full size flat washers with bolts and nuts.

Size	Bolt Circle Diameter	No. of Bolts	Bolt Size (UNC x Length)	Recommended Torque
1/2	2.37	4	1/2 - 13 x 1-3/4	15-20
3/4	2.75	4	1/2 - 13 x 1-15/16	15-20
1	3.12	4	1/2 - 13 x 2	15-20
1-1/4	3.50	4	1/2 - 13 x 2-1/4	15-20
1-1/2	3.87	4	1/2 - 13 x 2-3/4	15-20
2	4.75	4	5/8 - 11 x 3	20-30
2-1/2	5.50	4	5/8 - 11 x 3-1/4	20-30
3	6.00	4	5/8 - 11 x 3-5/8	20-30
4	7.50	8	5/8 - 11 x 3-3/4	20-30
5	8.50	8	3/4 - 10 x 3-3/4	25-35
6	9.50	8	3/4 - 10 x 4-3/8	33-50
8	11.75	8	3/4 - 10 x 4-3/8	33-50
10	14.25	12	7/8 - 9 x 4-1/2	53-75
12	17.00	12	7/8 - 9 x 4-5/8	53-75

*UNC=Unified National Course

Note: Mating dimensions and configuration conform to ANSI B 16.5, Class 150 flanges. Socket diameters conform to ASTM D-2467. Recommended working pressure: 150 psi water at 73.4 F. Use primer and heavy-bodied PVC cement in accordance with ASTM D-2855.

Decimal Equivalents

1/64 = 0.0156	13/64 = 0.2031	25/64 = 0.3906
1/32 = 0.0313	7/32 = 0.2188	13/32 = 0.4063
3/64 = 0.0469	15/64 = 0.2344	15/32 = 0.4688
1/16 = 0.0625	1/4 = 0.2500	1/2 = 0.5000
5/64 = 0.0781	17/64 = 0.2656	9/16 = 0.5625
3/32 = 0.0938	9/32 = 0.2813	5/8 = 0.6250
7/64 = 0.1094	19/64 = 0.2969	11/16 = 0.6875
1/8 = 0.1250	5/16 = 0.3125	3/4 = 0.7500
9/64 = 0.1406	21/64 = 0.3281	13/16 = 0.8125
5/32 = 0.1563	11/32 = 0.3438	7/8 = 0.8750
11/64 = 0.1719	23/64 = 0.3594	15/16 = 0.9375
3/16 = 0.1875	3/8 = 0.3750	

Schedule 80-CPVC

Sales Offices in Major Cities, Warehouses Nationwide:



www.lascofittings.com

Headquarters

414 Morgan Street
Brownsville, TN 38012
731/772-3180
800/776-2756
Fax: 731/772-0835

3450 Vineland Road
Orlando, FL 32811
407/648-5955
800/437-3155
Fax: 407/649-7999

4780 Holly Steet, Unit A
Denver, CO 80216
303/388-7204
888/388-5450
Fax: 303/388-7199

311 Richert
Wood Dale, IL 60191
630/860-7402
888/996-7414
Fax: 630/860-7416

3401 Pennsy Drive
Ardmore-Ardwick Industrial Park
Landover, MD 20785
301/322-3377
800/882-5462
Fax: 301/772-1627

6131 Knott Avenue
Buena Park, CA 90620
714/690-9579
800/966-2726
Fax: 714/736-1780

22473 72nd Avenue South
Kent, WA 98032
253/872-0185
888/295-2726
Fax: 253/395-0221

1228-A Crowley Circle
Carrollton, TX 75006
972/446-8776
800/642-8104
Fax: 972/466-2260

Standards and Specifications

- ASTM F-437** — Threaded Chlorinated Poly (Vinyl Chloride) (CPVC) Plastic Pipe Fittings, Schedule 80.
ASTM F-439 — Socket Type Chlorinated Poly (Vinyl Chloride) (CPVC) Plastic Pipe Fittings, Schedule 80.
ASTM D-1784 — Rigid Poly (Vinyl Chloride) (PVC) Compounds and Chlorinated Poly (Vinyl Chloride) (CPVC) Compounds.
MATERIAL — LASCO Schedule 80 CPVC Fittings are produced from CPVC Type IV, Grade 1. O-rings are produced from a fluorocarbon elastomer.
CPVC Fittings are listed by NSF (National Sanitation Foundation).

ATTENTION!

DO NOT use LASCO Fittings for **compressed air** or **gases**.
DO NOT test PVC piping systems with **compressed air** or **gases**.
DO NOT use fittings with liquids not recommended by LASCO.
Modifications of fittings voids the warranty.

LIMITED WARRANTY

LASCO fittings are made from 100% virgin materials and are warranted to be free from manufacturing defects in materials and workmanship. They are warranted against rot, rust and electrolytic corrosion for a period of 3 years from date of installation. If LASCO fittings prove defective due to manufacturing defects in material or workmanship during that period, the manufacturer will provide new replacement units of the same type and size. No remedy will be granted under this warranty if LASCO fittings are not used strictly in accordance with LASCO's directions with respect to use and storage or if the fittings have been modified in any way. THE MANUFACTURER'S LIABILITY UNDER EXPRESSED OR IMPLIED WARRANTY OR FOR ANY REASON IS LIMITED TO FURNISHING REPLACEMENT UNITS OR GRANTING CREDIT FOR DEFECTIVE UNITS. NO LABOR EXPENSE OR CONSEQUENTIAL DAMAGES WILL BE PAID BY LASCO. THIS WARRANTY IS IN LIEU OF ALL OTHER GUARANTEES AND WARRANTIES, EXPRESSED OR IMPLIED, INCLUDING BUT NOT LIMITED TO, WARRANTIES OF MERCHANTABILITY AND FITNESS FOR PURPOSE, EXCEPT FOR ANY WARRANTIES IMPLIED BY LAW FOR NONCOMMERCIAL CONSUMERS. ANY SUCH WARRANTIES ARE LIMITED TO THE DURATION OF THIS WRITTEN WARRANTY.